

THE INFORMATION CONTAINED IN THIS DRAWING IS THE SOLE PROPERTY OF SUSPA INCORPORATED. ANY REPRODUCTION IN PART OR AS A WHOLE WITHOUT THE WRITTEN PERMISSION OF SUSPA INCORPORATED IS PROHIBITED.

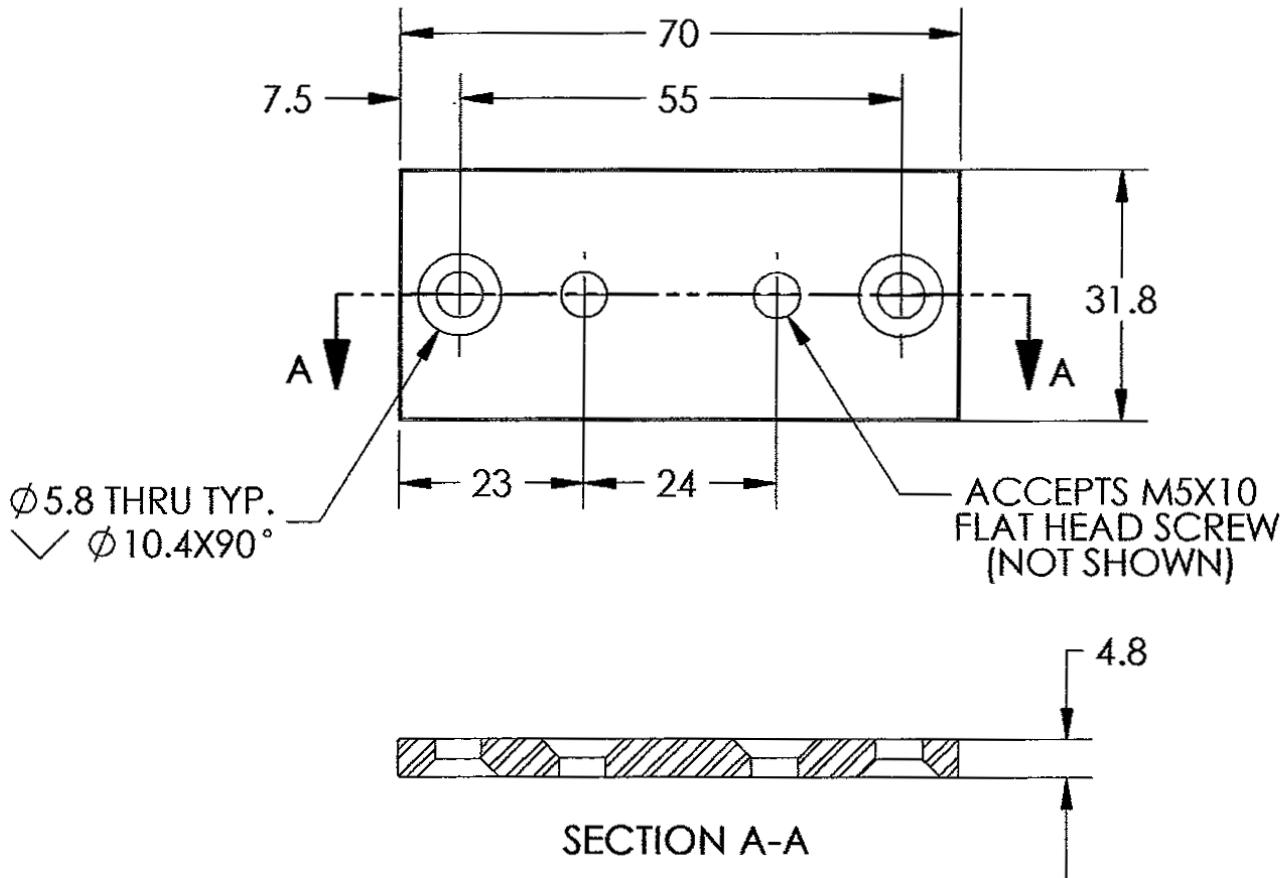

**NOTES:**

1.) ALL DIMENSIONS ARE REFERENCE ONLY.

2.) MATERIAL SPECIFICATIONS:

FLAT HEAD SCREWS: STEEL WITH ZINC PLATED FINISH.

LARGE MOUNTING BRACKET: ALUMINUM.

3.) LARGE MOUNTING BRACKET KIT (P/N: D44-00001) INCLUDES:  
 {2} LARGE BRACKETS, AND  
 {4} M5X10 FLAT HEAD SCREWS.

			JED	11/29/04
REV	ECN	REVISIONS	CHANGED BY	APPROVED BY
				DATE (MM/DD/YY)

DESCRIPTION **LARGE MOUNTING BRACKET (FOR CB CYLINDERS)**

MATERIAL **N/A**

DRAWING NUMBER **S44-0006**

	3970 Roger B. Chaffee S.E. Grand Rapids, Michigan 49548-3497	DRAWING SIZE
		<b>A</b>

**DO NOT MANUFACTURE TO THIS DRAWING UNLESS IT IS MARKED "CONTROLLED"**

**DO NOT SCALE THIS DRAWING**  
 DIMENSIONS ARE IN MILLIMETERS

**TOLERANCES UNLESS OTHERWISE SPECIFIED**

ONE PLACE DECIMAL	±0.2	ANGULAR	±2°
TWO PLACE DECIMAL	±0.1		

DRAWN BY	DATE	SCALE	
JED	11/29/04	1:1	

**CUSTOMER DRAWING**